

COLUMBUS COUNTY LAND RECORDS - PROPERTY RECORD CARD

PROPERTY#	TWSHP	PIN	0281.04-71-6865.000	LAST REVAL	PRIOR VALUE	CARD#	LEGAL DESCRIPTION				PROPERTY FACTORS						
1213	01	MAP	WH 3	329000	330600	2	LIBERTY HEALTHCARE PROPERTIES				ACCESS	TOPO	LND IMP	SHAPE			
1-05282			RECORD OF OWNERSHIP	BOOK	PAGE	YEAR	STAMPS	PROPERTY LOCATION				CLASS	OCCUP	04	01	00	00
COOK J WARREN (JR) & JOSEPH WARREN COOK (III) 507 E OLIVER ST WHITVILLE NC				28472	868	429	2006	30000	LISTED P 00#0000				BUILDING	% COMPLETE			
				APPR	DATE	ZONED	-- WH WR --										

A 06

ACT YR BLT	COND	EFF. YR BLT.	BUILDING ELEMENTS AND CALCULATIONS			
1964	A		VALUE	DESCRIPTION	VALUE	
FOUNDATION	04 PER. FT			ATTIC		
FLOORING SYSTEM	03 WD. FR.	BASE	1673	50.28		
STRUCTURAL FRM	01 WD. FR.	BASE	1673	50.27	84118	
EXTERIOR WALLS	01 BRI CK	BASE		01-1STY		
ROOF FRAMING	01 WD. FR.	BASE		WALL HEIGHT	1	
ROOF COVER	01 COMP.			ATTACHMENTS	6	
ROOF DESIGN	03 GABEL	BASE		COV P	120	1916
FLOOR COVER	02 H. WOOD	BASE				
INTERIOR FINISH	03 AVG.	BASE				
CAB/MILL WORK	03 AVG	BASE				
ELECTRICAL	03 AVG.	BASE				
PLUMBING FIXTURES	7	3500		PERIMETER MULT		
SPRINKLER SYSTEM				GRADE	100	102353
HEAT/COOL	07 P. H/AC	9619		DEPR P/F/E	45/20/	57318
FIREPLACE	104 1ST. SG	3200		TOTAL VALUE	45035 .00	45000
BASEMENT				NEIGHBORHOOD INFLUENCE		

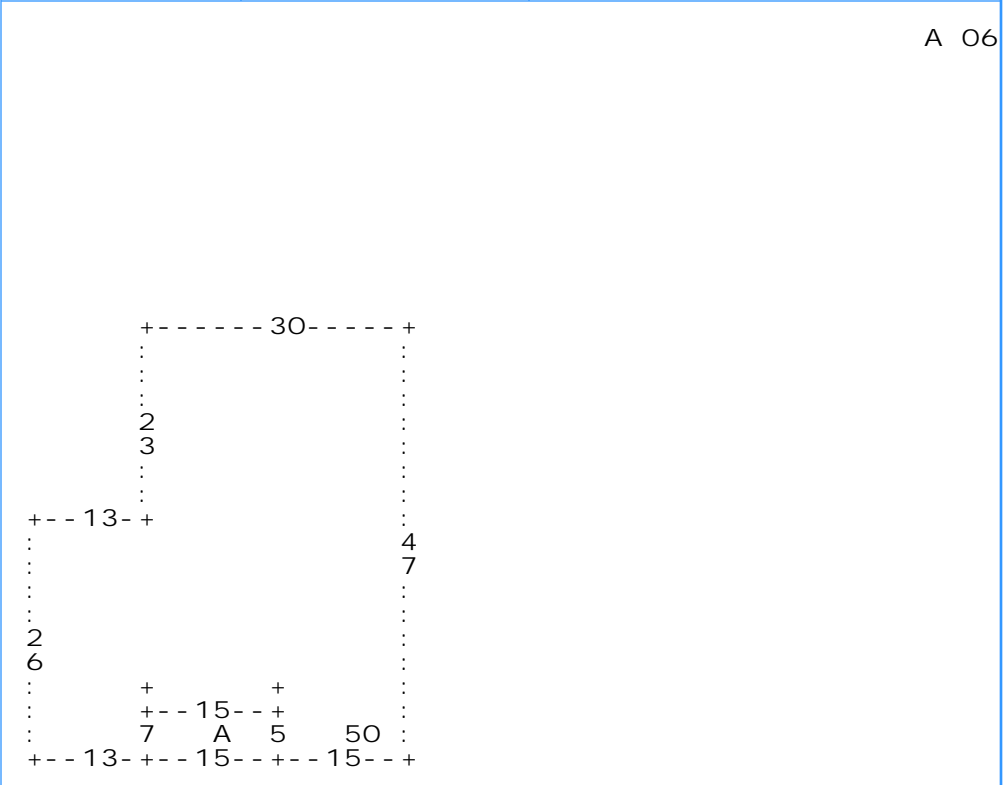

SUMMARY OF OTHER IMPROVEMENTS										
LINE #	CODE	DESCRIPTION	#	CONST	SIZE	AREA	RATE	YR	DEP	VALUE

LAND DESCRIPTION CALCULATIONS											
FRTG	DEPTH	UT PR	DEP FAC	FF PRICE	SUB TOTAL	SH	TOPO	R/W	OTHER	ADJ	LAND VALUE
SQUARE FOOTAGE				SF PRICE	SUB TOTAL	SH	TOPO	R/W	OTHER	ADJ	LAND VALUE
CLASS	ACRES	SIZE FAC	DIRT	FACT	RATE	LAND VALUE					

SALES INFORMATION			TOTAL VALUE SUMMARY OF OTHER IMPROVEMENTS							
AMOUNT:			TOTAL VALUE LAND							
DATE:			TOTAL VALUE BUILDINGS							
QUAL SALE:	NO -		TOTAL VALUE							
			45000							
			45000							

LAND USE VALUATIONS AND TOTALS										
CLASS	# ACRES	RATE	LAND VALUE	TOTAL USE VALUE LAND	TOTAL USE VALUE BUILDINGS	TOTAL USE VALUE				
BUILDING SITE										
TOTAL ACRES							2/06/12			

